

# Pratt Institute

## *Self-Guided Campus Tour*

200 Willoughby Avenue  
Brooklyn, NY 11205

718.636.3600  
pratt.edu

@prattinstitute

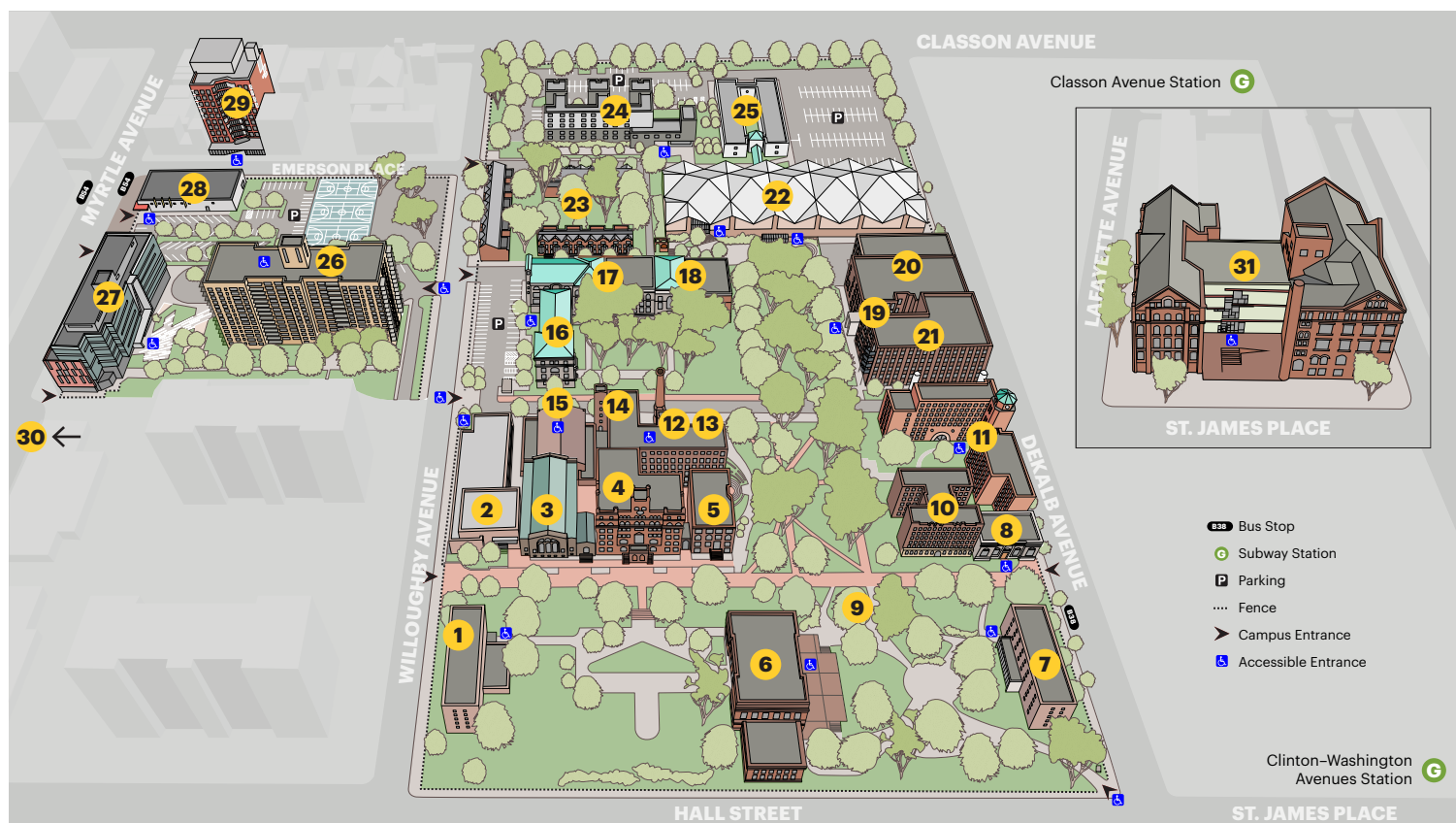

- |                  |   |   |                            |
|------------------|---|---|----------------------------|
| 1 ISC Building   | 10 Esther Lloyd Jones Hall (ELJ)                  | 19 Juliana Curran Terian Design Center Pavilion | 28 Film/Video Building     |
| 2 North Hall     | 11 Leo J. Pantas Hall                             | 20 Steuben Hall                                 | 29 Emerson Place Residence |
| 3 Memorial Hall  | 12 East Hall                                      | 21 Pratt Studios                                | 30 Grand Avenue Residence  |
| 4 Main Building  | 13 Center for Career and Professional Development | 22 Activities Resource Center (ARC)             | 31 Higgins Hall            |
| 5 South Hall     | 14 Pratt Chapel                                   | 23 Pratt Townhouses                             |                            |
| 6 Library        | 15 Student Union                                  | 24 Stabile Hall                                 |                            |
| 7 DeKalb Hall    | 16 Chemistry Building                             | 25 Cannoneer Court                              |                            |
| 8 Thrift Hall    | 17 Machinery Building                             | 26 Willoughby Hall                              |                            |
| 9 Sculpture Park | 18 Engineering Building                           | 27 Myrtle Hall                                  |                            |



1

### Information Science Center (ISC) Building 1954–55

Originally built as a dormitory, the ISC Building now houses the Learning/Access Center and The Black Alumni of Pratt. It is also home to the Franklin Furnace Archive, which is dedicated to avant-garde and performance art and therapy offices.

After the acquisition of Willoughby Hall in the 1960s, both the ISC and Willoughby were used for offices and classrooms. They were built during the extensive Pratt Area Urban Renewal under the direction of Robert Moses.



2

### North Hall 1958

Pratt's dining services (the cafeteria and the Pi Shop) are located within North Hall, providing the student community with healthy and fresh options for breakfast, lunch, and dinner. There are several different meal plans to choose from, and students living both on campus and off campus can sign up. The cafeteria is a traditional dining hall with options for hot meals, grab-and-go sandwiches, a salad bar, grilled entrées, and sushi. The Pi Shop serves pizza, calzones, pasta, and rice bowls. Pratt's dining services strive to accommodate dietary restrictions and will always offer a variety of meal options.

Also in North Hall is the Writing and Tutorial Center, which offers free tutoring in writing, speaking, art history, math/science, and graduate thesis to all current Pratt students, regardless of program or status. Classrooms in North Hall are typically used for some of Pratt's Liberal Arts courses.



3

### Memorial Hall 1926–27

A large auditorium/theater built by the Pratt family in memory of Mary Richardson Pratt, the wife of founder Charles Pratt, Memorial Hall hosts numerous events and productions throughout the year, including Pratt Presents, the Institute's signature series of free public programs, visiting artist talks, panel discussions, performances, theater productions, and more.

Recent speakers have included visual artist Kara Walker and filmmaker Spike Lee. In years past, we have hosted talks by renowned architect Frank Gehry, legendary editor-in-chief of *Vogue* magazine Anna Wintour, accomplished graphic design alumnus Stefan Sagmeister, award-winning director/screenwriter and journalist Ava DuVernay alongside *The New York Times* bestselling author/filmmaker/producer and frontman for The Roots, Questlove. The list goes on.



4

### Main Building 1885–87

Pratt Institute opened in 1887 with a drawing class of 12 students. As the first campus building, the Main Building originally housed all of the Institute's programs and courses. This red brick building was designed in the Romanesque Revival style popular in the 1880s and is six stories high with picturesque corner towers and a central clock tower. The porch was added in 1895. The heart of the Pratt campus, the Main Building is home to the President's Office, classrooms and studios, and senior painting studios located on the 6th floor. It is also an NYC Designated Historical Landmark.



5

**South Hall** 1889–91

Designed by the same architect as the Library, South Hall was originally Pratt High School, a three-year coed program. After the program was discontinued, South Hall was repurposed for the Household Science program, and then later the Costume Design Building. South Hall is now home to our Foundation and Fine Arts Departments.



6

**Library** 1896

This Victorian Renaissance revival structure was built both as a public and college library. However, as the Institute grew and the Brooklyn Public Library system expanded, it ceased being used as a public library in 1941. Designed by the Tiffany Glass Co., the interior has a marble and brass central staircase, glass floors, and numerous mosaics.

In addition to our collection of over 235,000 books, Pratt's library resources include thousands of online books, journals, and articles, and special collections including artist's books, zines, and more. The Library also houses the Pratt Institute archives of historical documents, images, and videos. Students have access to films, videos, projectors, cameras, and lighting equipment for check out. There are also a number of study spaces available, rotating exhibitions of artwork, and the Alumni Reading Room, which hosts fun and educational programming, including film series and guest speakers.



7

**DeKalb Hall** 1954–55

DeKalb Hall houses classrooms, offices, and most notably the DeKalb Gallery, which hosts student thesis shows and other various exhibitions throughout the year.



8

**Thrift Hall** 1916–17

Thrift Hall houses the Pratt mail center, where students can pick up and ship all of their important packages. Incoming students can pre-ship supplies for their residence hall rooms so that everything is there when they arrive on campus for orientation.



9

**Sculpture Park**

Pratt's Sculpture Park is one of the largest in New York City. Well-known and emerging artists loan their work to the exhibition, and the park includes a number of commissioned works as well.



10

**Esther Lloyd Jones Hall (ELJ) 1921**

ELJ was a private apartment building that was purchased by Pratt Institute in 1964 and became a residence hall for juniors and seniors. As a historic building, many of the dorm rooms still boast original architectural details. All students in ELJ are provided with a bed (twin extra long), a drafting table or desk, chair, dresser, and a microwave/refrigerator/freezer unit.



11

**Leo J. Pantas Hall 1986–87**

A contemporary residence hall for students, this brick building houses approximately 212 students in suite-style room layouts. All rooms are air-conditioned and students are provided with a bed (twin extra long), a drafting table or desk, chair, dresser, and a microwave/refrigerator/freezer unit.

Other features of Pantas include a first-floor common area with a TV and a large communal work area available to students. Pantas also has Learning Communities (such as Community Service, Art History, and Humanities) and Specialty Housing options (like Quiet Floors and Healthy Choices) available.



12

**East Hall 1887**

East Hall is one of the buildings in the complex making up Pratt's original campus and although it is connected to the Main Building, the two buildings had different architects. The building wraps around an attractive courtyard and the first floor houses Pratt's engine room, a National Historic Mechanical Engineering Landmark. The engine room was built in 1887 and is the oldest maintained site for steam engines producing electricity in NYC and the Northeast. On New Year's, antique steam whistles from ocean liners, trains, and riverboats blast sound across the campus. Many students choose to visit the engine room for their first-year 2D drawing class. This space is a wonderful area for observational and perspective drawing; it is an ideal space because it challenges your drawing skills.

East Hall also houses classrooms, studios, the Pratt Chapel, and our Center for Career and Professional Development.

13

**Center for Career and Professional Development**

(inside East Hall)

The Center for Career and Professional Development (CCPD) provides lifelong access to career management education, inspiration, and support for students and alumni to develop their full potential as creative practitioners with clarity, competence, and confidence. The CCPD offers over 120 professional development programs and 10 specialized recruitment events throughout the year. The CCPD staff are here to help you prepare and polish your résumé and portfolio, and work with you on strategies for attaining internships, approaching and presenting yourself to industry professionals, and searching for and applying for jobs and career opportunities.

14

**Pratt Chapel (inside East Hall)**

The chapel provides all Pratt students with a safe setting for meditation or to celebrate interdenominational rites as a campus community. Any group wishing to use the chapel may contact a campus minister, whose only requirement is respect for the space and its purpose.



15

**Student Union 1887**

Renovated in 2018, the Student Union is where Student Government, the Program Board, and the Community Engagement Board have offices, along with student clubs and organizations. As the campus “living room,” students can hang out here, study, eat lunch, or just relax. Throughout the academic year, the Student Union holds events such as movie screenings, lectures, and music and comedy shows, and during exam weeks, Late Night Breakfasts.

Originally, the Student Union was the Trade School Building and was used for courses on bricklaying, plumbing, and sign painting before transitioning to become Pratt’s old gymnasium. There was a small swimming pool (actually called a “swimming tank,” and was the first in Brooklyn to admit women) located under the staging area on the east side of the building, and some of the original signage from the pool can still be seen in the Student Union today.



16 17 18

**Chemistry Building 1904–05****Machinery Building 1914****Engineering Building 1928–29**

This complex of three buildings contains a variety of facilities and studios for printmaking, sculpture, ceramics, jewelry, welding, metalworking, and woodshop. There are also computer labs and The Rubelle and Norman Schafler Gallery. These studios are open to all Pratt students and most can be used with a short introductory shop lesson/certification class. All students are encouraged to take elective studios outside of their majors and can usually do so in their junior and senior years. Studio techs are available for assistance using specialized equipment.



19

**Juliana Curran Terian Design Center Pavilion 2007**

This 6,000-square-foot building embodies Pratt’s focus on integrative learning and research. It connects two older buildings with a contemporary bridging structure to consolidate Pratt’s four design programs (interior, fashion, industrial, and communications design) into a unified setting where faculty and students teach, work, and learn from one another. The pavilion includes a shared entrance lobby facing the campus mall, gallery, lecture space, and courtyard area. The second-floor gallery space hosts cross-curricular lectures and shows, and there is a café on the first floor.



20

**Steuben Hall**

Steuben was the United Metals factory, which manufactured small metal items, prior to being acquired by Pratt in the early 1970s. It now houses numerous studio spaces, classrooms, and galleries, and is home to our Fashion Design and Communications Design Departments. Students have access to the digital printing lab and resource center, as well as fashion production studios.



21

### Pratt Studios

This former industrial building acquired by Pratt in 1962 was converted for use as art and design studios and classrooms. Pratt Studios is home to our Industrial Design and Interior Design Departments. Facilities include laser cutters, 3D printers, and a woodshop and casting studio.



22

### Activities Resource Center (ARC) 1974

The Activities Resource Center, or simply known as “the ARC,” is home to the Cannoneers and the recreation, wellness, and intramural sports programs at Pratt Institute. The ARC offers six multipurpose athletic courts that can be used interchangeably for basketball, tennis, and volleyball. A four-lane 200-meter track lines the perimeter of the gym floor. The ARC’s activity areas and resources also include a studio room, a fitness center (weights and cardio machines), and a boxing and functional space.



23

### Pratt Townhouses 1901–10

Pratt Townhouses are remodeled historic row houses located near the center of campus. Six students reside in each house in single rooms on three floors. Each house is coed and offers a full kitchen, living room, parlor, backyard area, and basement. Each room is provided with the standard campus furniture (bed, armoire, dressers, desk, chair, and bookshelf). Amenities include washer and dryer, WiFi, and Philo streaming TV. Preference for this housing option is given to junior- and senior-level students.



24

### Stabile Hall 1999

Stabile Hall was designed to house new undergraduate students with space for 224 first-year students in four-person suites. Each suite consists of two air-conditioned double rooms with a shared bath and each room is furnished with the standard campus furniture (extra-long twin bed, dresser, desk, chair, and bookshelf). There are kitchenettes located on each floor and laundry in the basement. Each floor has a large common lounge with smaller work and lounge spaces, all of which contribute to a vital living and working environment. Suites are single sex, but floors are coed. Stabile Hall hosts the Healthy Choices and Global Learning Communities.



25

**Cannoneer Court** 1986

Cannoneer Court is the home of Pratt's Writing BFA, which uniquely offers maker's spaces, performance spaces, their own computer labs, and a small library. Students also have access to the courtyard garden.



26

**Willoughby Hall** 1974

Willoughby Residence Hall is a former 17-story apartment co-op, and is the largest residence hall. Former apartments have been converted to suites with the living room space transformed to doubles and triples and the bedroom spaces transformed to single rooms. It accommodates 850 undergraduate men and women. With the exception of the Gender Inclusive Community, suites are single sex, but floors are coed. Rooms vary in size from 9' x 12' to 15' x 20' with the larger spaces being triple occupancy rooms. In addition to the standard furniture, all suites have a kitchen table, stove, and refrigerator. Many continuing/upperclass students call Willoughby home as well as most new transfer students.

Willoughby Hall hosts the Healthy Choices Community, Global Learning Community, Quiet Floors, Gender Neutral Floor, and Community Service Floor. The building is also home to our Health Services Office, Pratt convenience store, and Residential Life and Housing Offices.



27

**Myrtle Hall** 2011

Myrtle Hall is Pratt's 120,000-square-foot, green, academic, and administrative building on the Myrtle Avenue commercial strip. It is home to many offices and invaluable resources for both prospective and current Pratt students and their families:

- **The Office of Admissions:** Located on the 2nd floor, prospective students are invited to connect with one of our admissions counselors to access support and guidance prior to starting and throughout the application process. Students can schedule a portfolio review or sign up for a guided tour of our campus with one of our student tour guides.
- **The Office of International Affairs (OIA):** Also housed on the 2nd floor, OIA provides support, resources, and programming for our international students. OIA is the office responsible for issuing I-20s for student visas and provides guidance/support for on-campus employment as well as CPT and OPT.
- **Academic Advisement Office:** Pratt's Academic Advisement Office is on the 6th floor of Myrtle Hall. All students have an assigned academic adviser who is there to help them register for classes, discuss curriculum planning, and offer general support.
- **Student Financial Services and Bursar's Office:** These offices can also be found on the 6th floor and provide support for students with regard to financial aid, bill payments, and other financial services.

The Office for Institutional Advancement and Pratt's Human Resources Office are also located in Myrtle Hall.

In addition to these student support services, Myrtle Hall is home to our Digital Arts and Game Arts Departments. Facilities for these majors are equipped with state-of-the-art computer labs, tablets, inkjet printers, and more.

Myrtle Hall recently met the United States Green Building Council standards for LEED (Leadership in Energy and Environmental Design) Gold certification based on its eco-friendly features that include exterior sun shades; a green roof that absorbs rainwater, reflects heat, and sequesters greenhouse gasses; and solar photo-voltaic panels that generate on-site electricity.



28

### Film/Video Building

Located at 550 Myrtle Avenue on the Brooklyn campus, this 15,000-square-foot facility serves as the home for Pratt's Film/Video Department. Facilities include state-of-the-art soundstages, greenscreens, editing suites, camera equipment, and a beautiful screening room.



29

### Emerson Place Residence 2019

The newest residence option on campus, Emerson Place is a 10-story community for first-year students and is conveniently located adjacent to the Film/Video Building, expanding the Pratt campus east. Each floor offers 12 double rooms and 10+ private bathrooms arranged around a central floor lounge with kitchenettes, and dramatic views of the campus and lower Manhattan. On the first floor of Emerson, there is a large main lounge, student maker space, and a meeting space, with laundry and bike storage located in the basement. All residence hall students are provided with a bed (twin extra long), a drafting table or desk, chair, dresser, and a microwave/refrigerator/freezer unit.



30

### Grand Avenue Residence

Grand Avenue Residence is located one block from campus at 100 Grand Avenue and accommodates 60 students, both graduates and undergraduates, in a variety of apartment-style options. Students may choose to live with a roommate in a one-room apartment, share an apartment with another student in their own private bedrooms, or opt for a larger apartment shared by three students in a single bedroom. Each apartment has a kitchen equipped with a refrigerator and stove, and, as with all residence halls, students' rooms are furnished with beds, desks and chairs, dressers, bookshelves, and a dining table and chairs.



31

### Higgins Hall 1868

Before becoming Pratt's School of Architecture, Higgins Hall was originally built as Adelphi Academy, a private school that later evolved into Adelphi University and relocated to Garden City, NY. The original building gained east and west wings in 1868 and 1871, respectively, and a second building in 1889. Higgins was acquired by Pratt in 1963 with an endowment by Mrs. John Higgins, for whom the complex was renamed. In 1996, a four-alarm fire caused significant damage to the central and north wings of the building. The resulting repairs and updates to infrastructure were designed to work with the School of Architecture and the Graduate Center for Planning and the Environment along with our robotics lab.